

Swivel Elbows (SE)

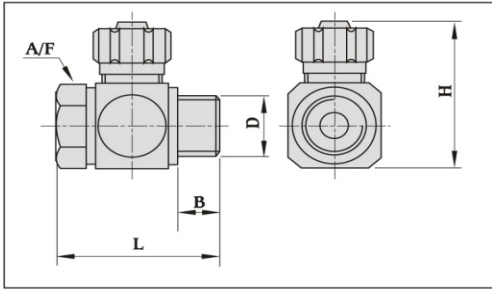

Basic Dimensions



Material : Aluminium
Finish : Blue anodised

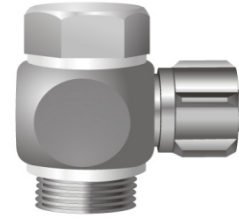

Order code No. and type	Tube ID in mm	Connection (D)	Nominal Bore in mm	Dimensions			
				B mm	H mm	L mm	A/F
SE - M5 - PU - 3	3	M5	2.4	5.0	19.5	19.5	8 mm
SE - M5 - PU - 4	4	M5	3.4	5.0	23.0	19.5	8 mm
SE - 1/8" - PU - 3	3	1/8" BSP	2.4	6.0	26.0	22.0	1/2"
SE - 1/8" - PU - 4	4	1/8" BSP	3.4	6.0	29.0	28.0	1/2"
SE - 1/8" - PU - 6	6	1/8" BSP	5.3	6.0	29.0	28.0	1/2"
SE - 1/8" - PU - 8	8	1/8" BSP	7.0	7.0	37.5	29.5	1/2"
SE - 1/4" - PU - 3	3	1/4" BSP	2.4	6.0	29.0	29.5	5/8"
SE - 1/4" - PU - 4	4	1/4" BSP	3.4	7.0	32.5	29.5	5/8"
SE - 1/4" - PU - 6	6	1/4" BSP	5.3	7.0	32.5	29.5	5/8"
SE - 1/4" - PU - 8	8	1/4" BSP	7.0	7.0	38.0	34.0	5/8"
SE - 1/4" - PU - 9	9	1/4" BSP	8.0	8.0	38.0	34.0	5/8"
SE - 3/8" - PU - 6	6	3/8" BSP	5.3	8.0	38.5	31.5	7/8"
SE - 3/8" - PU - 8	8	3/8" BSP	7.0	8.0	43.5	41.0	7/8"
SE - 3/8" - PU - 9	9	3/8" BSP	8.0	9.0	44.0	41.0	7/8"
SE - 1/2" - PU - 6	6	1/2" BSP	5.3	8.0	45.0	40.0	1"
SE - 1/2" - PU - 8	8	1/2" BSP	7.0	8.0	51.0	45.0	1"
SE - 1/2" - PU - 9	9	1/2" BSP	8.0	9.0	51.0	45.0	1"
SE - 1/2" - PU - 13	13	1/2" BSP	12.0	10.0	51.5	50.0	1"

Swivel Tee (ST)

Basic Dimensions

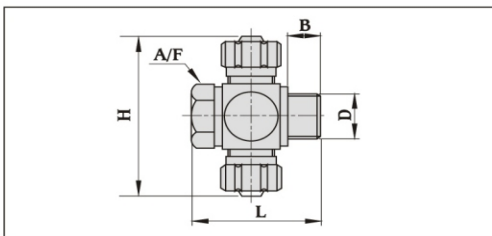

Material : Aluminium
Finish : Blue anodised

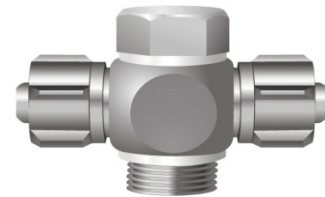

Order code No. and type	Tube ID in mm	CONNECTION (D)	Nominal Bore in mm	Dimensions			
				B mm	H mm	L mm	A/F
ST - 1/8" - PU - 3	3	1/8" BSP	2.4	6.0	36.0	22.0	1/2"
ST - 1/8" - PU - 4	4	1/8" BSP	3.4	6.0	43.0	28.0	1/2"
ST - 1/8" - PU - 6	6	1/8" BSP	5.3	6.0	43.0	28.0	1/2"
ST - 1/4" - PU - 4	4	1/4" BSP	3.4	7.0	46.0	29.5	5/8"
ST - 1/4" - PU - 6	6	1/4" BSP	5.3	7.0	46.0	29.5	5/8"
ST - 1/4" - PU - 8	8	1/4" BSP	7.0	7.0	56.0	34.0	5/8"
ST - 3/8" - PU - 6	6	3/8" BSP	5.3	8.0	52.0	31.5	7/8"
ST - 3/8" - PU - 8	8	3/8" BSP	7.0	8.0	62.5	41.0	7/8"
ST - 3/8" - PU - 9	9	3/8" BSP	8.0	9.0	62.5	41.0	7/8"

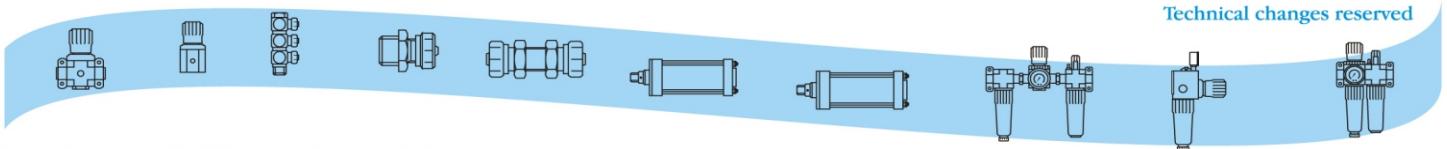

Technical changes reserved