

FOOT OPERATED VALVE WITH PROTECTIVE COVER

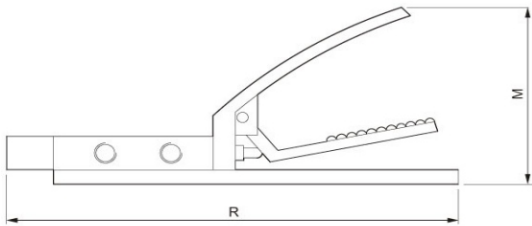

Pipe Size : 1/4" / 3/8" / 1/2" BSP
Valve Body : Aluminium
Pressure : 1-10 BAR
PORTS : 5 PORT / 3 PORT

Overall Dimensions details



The foot pedal valve with cover is an improvement of the conventional type Foot pedal valve. The Protective cover eliminates the risk of any object / tool falling on the foot pedal & activating the pneumatic system by mistake. The base plate raises the valve from the ground level which results in ease of operation and prevents any dirt entering the exhaust ports and affecting the performance of the valve.

Base Plate Mounting

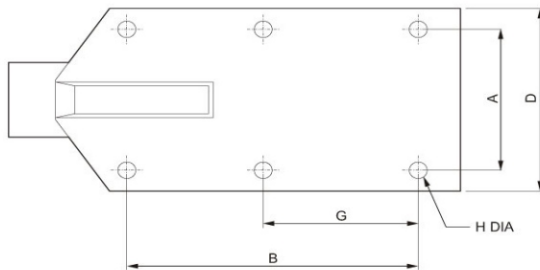

Size	A	B	H	D	G	R	M
1/4 BSP	76	167	6.5	95	-	230	160
3/8 BSP	86	-	6.5	101	130	295	210
1/2 BSP	86	-	6.5	101	130	295	210

.....1

Luthra Hydro Pneumatic Industries, Mumbai